

# Evidence of performance

## Airborne sound insulation of building components

### Test report

No. 15-001312-PR01  
(PB M06-A01-04-en-01)



Client	Keller AG/SA Route de Wilwerdange 38-40 9911 Troisvierges Luxembourg
Product	Sliding door, single leaf, Fixed light as fixed sash
Designation	minimal windows®4+
Overall dimensions (w x h)	4,190 mm x 2,980 mm
Material	Aluminium plastic composite profiles
Type of opening	Scheme A
Rebate seals	1 external seal, 1 internal seal, 2 central joint seal
Filling	Insulating glass unit , 8LSG/12/6ESG/12/12LSGSC
Special features	-/-

#### Basis

EN ISO 10140-1: 2010  
+A1: 2012 + A2:2014  
EN ISO 10140-2: 2010  
EN ISO 717-1: 2013  
15-001312-PR01 (PB M06-A01-04-de-02) dated 11<sup>th</sup> of September 2015

#### Representation

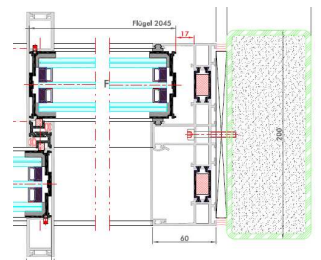

#### Instructions for use

This test report serves to demonstrate the airborne sound insulation of a building component.

Applicable for Germany

-  $R_{w,R}$  as per DIN 4109:  
( $R_w$  corresponds to  $R_{w,P}$ ,  
 $R_{w,R} = R_{w,P} - 2$  dB)

#### Validity

The data and results given relate solely to the tested and described specimen.

Testing the sound insulation does not allow any statement to be made on any further characteristics of the present construction regarding performance and quality.

Weighted sound reduction index  $R_w$   
Spectrum adaptation terms C and  $C_{tr}$



$$R_w (C; C_{tr}) = 43 (-1; -5) \text{ dB}$$

ift Rosenheim  
14.09.2015

Bernd Saß

Bernd Saß, Dipl.-Ing. (FH)  
Deputy Head of Testing Department  
Building Acoustics

Henning Mörchen

Henning Mörchen, Dipl.-Ing. (FH)  
Operating Testing Officer  
Building Acoustics

#### Notes on publication

The ift Guidance Sheet "Conditions and Guidance for the Use of ift Test Documents" applies.

The cover sheet can be used as an abstract.

#### Contents

The test report contains a total of 17 pages:

- 1 Object
  - 2 Procedure
  - 3 Detailed results
  - 4 Instructions for use
- Data sheet (1 page)